

SURVEY LEGEND

- SUBJECT PROPERTY LINE
- ADJOINING PROPERTY LINE
- - - - UTILITY EASEMENT
- +—+ SEWER LINE

- ⊗ 1/2" IRON ROD WITH YELLOW PLASTIC CAP MARKED "KERR 4502" FOUND
- ⊕ 1/2" IRON ROD W/ MAROON PLASTIC CAP MARKED "RPLS 6132 - ATM SURV" FND.
- ⊙ CALCULATED CORNER ⊗ 1/2" IRON ROD FOUND

Survey Notes:

- 1). The bearings of this survey are based on the Texas State Plane Coordinate System, Central Zone, NAD83(2011) EPOCH 2010, and boundary referenced to 1/2" iron rods called for and found as noted on the previous recorded plat.
- 2). Drawing Scale is 1"=40'
- 3). Drawn by: Adam Wallace
- 4). Said lot does not appear to be under the 100 year flood plain, as identified by the Federal Emergency Management Agency on Community Panel No. 48041C0185E effective date, 05-16-2012

I, Adam Wallace, Registered Professional Land Surveyor No. 6132, do hereby certify that the above survey is a true and accurate representation of an actual on the ground survey performed on May 4th, 2022, made under my supervision and that there are no encroachments or overlaps unless otherwise shown.

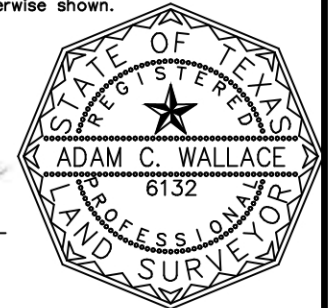

Adam Wallace

Adam Wallace
Texas Registered Professional
Land Surveyor, Number 6132

EASEMENT EXHIBIT

AREA: 0.0663 ACRES
 LOT: THREE(3), FOUR(4)
 SUBDIVISION: WOODVILLE ACRES ADDITION
 -VOL. 17520, PAGE 266
 STREET ADDRESS: 3707 OLD HEARNE ROAD
 CITY: BRYAN, TEXAS
 COUNTY: BRAZOS

ATM Surveying

P.O. Box 10313, College Station, TX 77840
 PHONE: (979)209-9291 email: Adam@ATMsurveying.com
 www.ATMsurveying.com - FIRM #101784-00